

Hold Open Restrictor Stay

Fitting Instructions

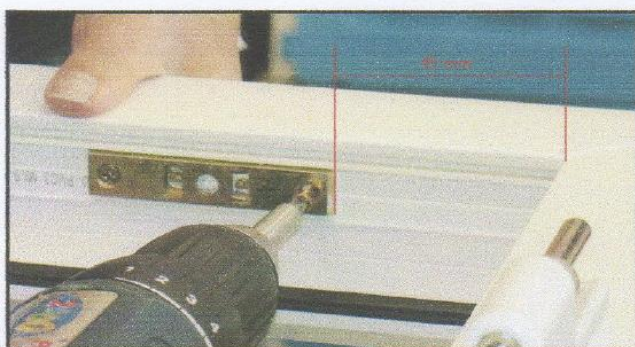

1. Position the restrictor onto the head of the door sash 105mm from the sash rebate corner on the hinge side.



2. Position the anchor plate behind the bead groove on the outer frame 45mm from the corner and screw into position

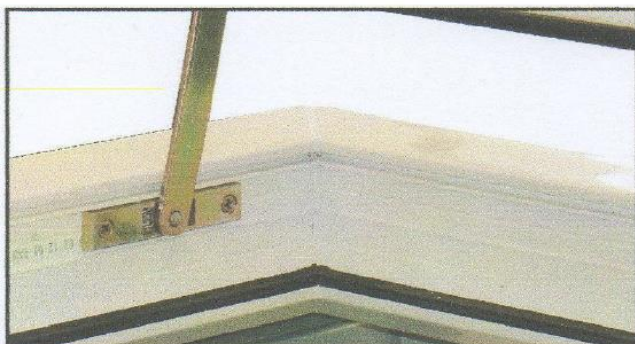

3. After hanging the sash, clip the arm of the restrictor into the anchor plate.

Note: Should additional friction be required simply tighten the pozi screw in the friction pad.



Hold Open Door Restrictor Stay

D-TECH 1000 STAY

90 Degree break stay and restrictor for doors

Order information:
D-tech stay with stainless steel arm
Part No. **1000/335-SS**

Note: Anchor plate included

Tel: 0121 526 2681
Email: sales@dynatech.uk.com
www.dynatech-uk.co.uk

DYNATECH

8-9 Owen Road
Owen Road Ind. Est.
Willenhall
WV13 1QH

